

FLOORPLAN

Borrower: _____ File No.: mk508Princetonm
 Property Address: 609 Princeton _____ Case No.: _____
 City: Fort Collins _____ State: CO _____ Zip: _____
 Lender: Wynn Washle _____

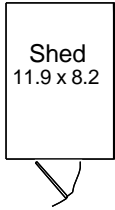

Total SF: 2234
 Total Finished SF: 1972
 Fin. SF w/o Bsmt: 1117
 Bsmt. SF: 1117
 Finished Bsmt: 77%

*Scope of work is defined and included with this sketch

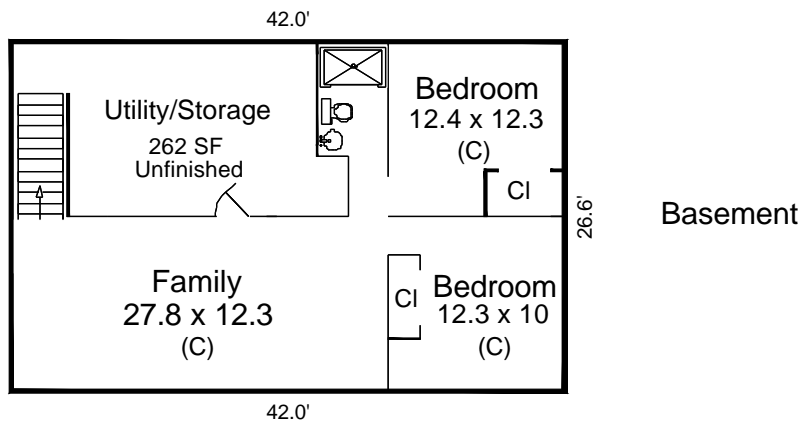
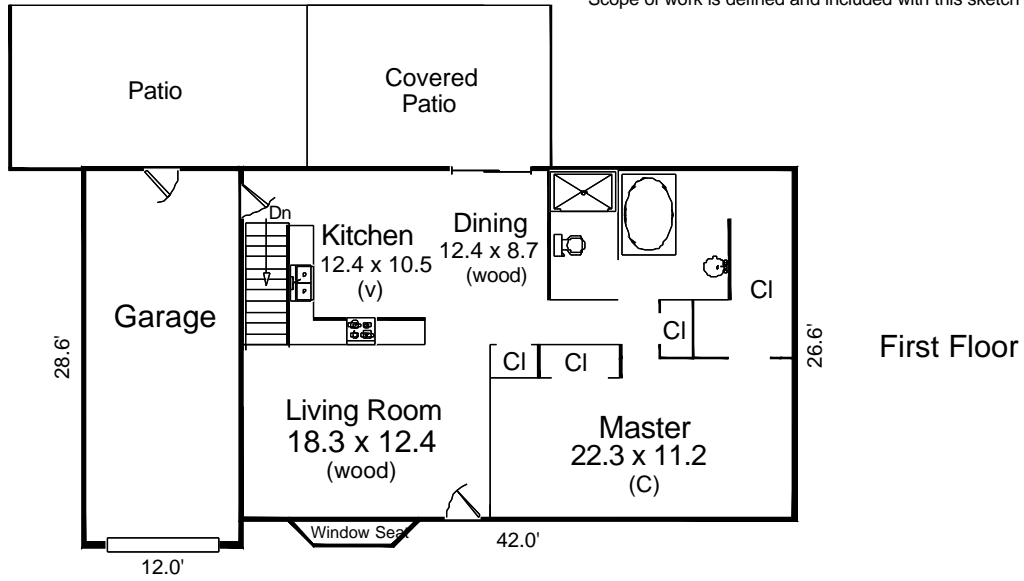

Appraisal Dimensions, LLC
 www.appraisaldimensions.com
 Catherine T. Miles, CRA
 Mary Kay Loner, RA

May 23, 2008

FLOORPLAN

Borrower: _____ File No.: mk508Princetonm
 Property Address: 609 Princeton _____ Case No.: _____
 City: Fort Collins _____ State: CO _____ Zip: _____
 Lender: Wynn Washle _____

AREA CALCULATIONS SUMMARY			
Code	Description	Net Size	Net Totals
GLA1	First Floor	1117.2	1117.2
BSMT	Basement	1117.2	1117.2
GAR	Garage	343.2	343.2
Net LIVABLE Area		(Rounded)	1117

LIVING AREA BREAKDOWN		
Breakdown	Subtotals	
First Floor	1117.2	
26.6 x 42.0		
1 Item	(Rounded)	1117

Garage	GAR
12.0 x 28.6 =	343.2
Area total (Rounded) = 343	

First Floor	GLA1
26.6 x 42.0 =	1117.2
Area total (Rounded) = 1117	

Basement	BSMT
26.6 x 42.0 =	1117.2
Area total (Rounded) = 1117	

May 23, 2008

The Group Inc.
Mulberry
Wynn Washle

File Number: mk508Princetonm

In accordance with your request, I have measured the following home and provided a sketch of the floor plan. Square footage is taken from outside measurements as per ANSI (American National Standards Institute) guidelines which are the guidelines to which HUD refers, with the exception of below grade finished areas. In this case we follow local custom which is to include garden levels in finished above grade square footage.

609 Princeton
Fort Collins, CO

Homes where outside measurements are inaccessible, inside measurements are used & an additional .5' is added for the outside wall. In rooms with sloping ceilings, the area measured is from where the ceiling is at least 5' high. Rms that are not square or rectangular, measurements are taken from the longest points in most cases. Attached dwellings are measured from the centerline between units where appropriate. Rms are rounded to the nearest .5 ft. Bedrooms are measured excluding closets. Kitchens are measured wall to wall & include the nook if applicable.

May 23, 2008

Mary Kay Loner, Registered Appraiser
Appraisal Dimensions
481-4541 (Cell) 866-332-0043 (Fax)

THANK YOU FOR YOUR BUSINESS