

FLOORPLAN

Borrower:	File No.: b13100RockwoodDrM
Property Address: 3100 Rockwood Drive	Case No.:
City: Fort Collins	State: CO
Lender: Agent: Wynn Washle	Zip: 80525

Total SF: 1998  
 Total Finished SF: 1804  
 Finished w/o Bsmnt: 1564  
 Basement SF: 434  
 Basement Finish: 52%

Scope of Work is defined and included with this sketch

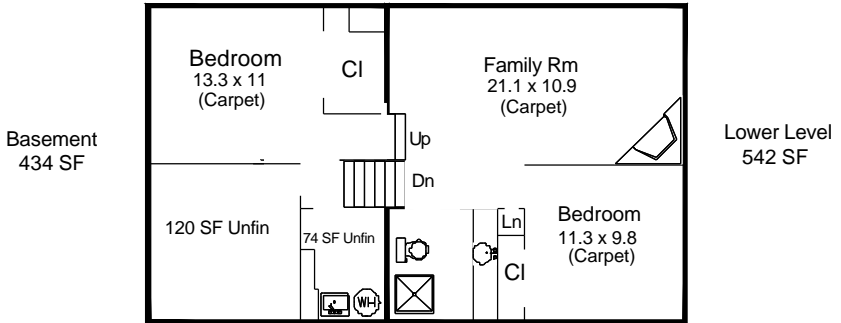
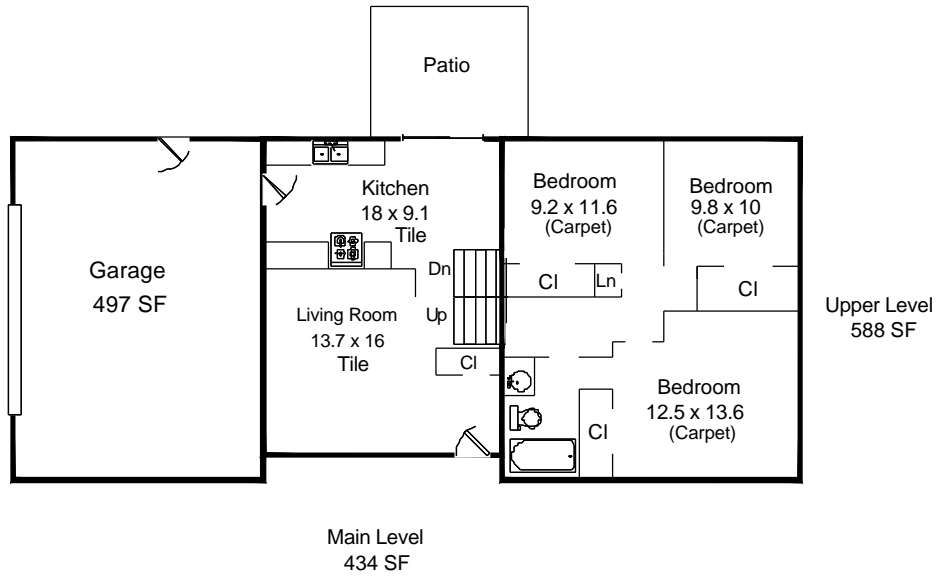

Appraisal Dimensions, LLC  
 www.appraisaldimensions.com  
 Catherine T. Miles, CRA  
 Bob Loner  
 January 5, 2012

Agent: Wynn Washle  
Office: Mulberry

File Number: bI3100RockwoodDrM

**SCOPE OF WORK:**

In accordance with your request, I have measured the following home and provided a sketch of the floor plan. Square footage is taken from outside measurements as per ANSI (American National Standards Institute) guidelines which are the guidelines to which HUD refers, with the exception of below grade finished areas. In this case we follow local custom which is to include the garden level in tri-levels in finished above grade square footage.

3100 Rockwood Drive  
Fort Collins, CO 80525

Homes where outside measurements are inaccessible, inside measurements are used & an additional .5' is added for the outside wall. In rooms with sloping ceilings, the area measured is from where the ceiling is at least 5' high. Rms that are not square or rectangular, measurements are taken from the longest points in most cases. Attached dwellings are measured from the centerline between units where appropriate. Condos are measured from interior walls. Bedrooms are measured excluding closets. Kitchens are measured wall to wall & include the nook if applicable.

All totals are estimates based on exterior dimensions. It is not unusual for 2 different appraisers to arrive at slightly different totals.

Bob Loner  
Appraisal Dimensions, LLC  
970-231-2222 (Cell) 866-332-0043 (Fax)

THANK YOU FOR YOUR BUSINESS